

## How to lay Witex Laminate Flooring:

- 1) Tools required: Tape measure, hammer, pencil, wooden/plastic wedges, power or hand saw, pull bar, utility knife, and a tapping block.
- 2) Aesthetically, laminate floors should be laid parallel to the direction of the incoming light. This helps to diminish the appearance of long seams between panels. In long narrow rooms, you should lay the laminate floor parallel to the long wall. In doing this you will have a nicer installation, and you will improve the structural stability of the floor along with reducing the amount of cutting required during installation.

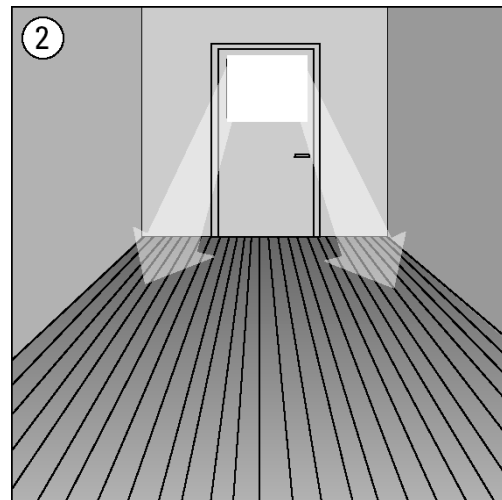

- 3) When you are laying Witex laminate in several rooms, it will be necessary to trim the doorjamb, and entryways in all of the affected areas. There should be a gap of at least 10mm to all fixed objects and walls in the room. Rooms with a maximum of 100m<sup>2</sup> are possible to install. For rooms larger than 100m<sup>2</sup> you will need to include expansion breaks in the floor, particularly if lengths are longer than 10m. The rule is to allow 1.5mm for every 1m of wall length. This additional expansion gap cannot be occupied by anything.
- 4) First the subfloor has to be appropriately prepared. Then the underlay material of your choice should be installed. In order not to damage your underlay, you should only install enough to advance 5-10 rows at a time.

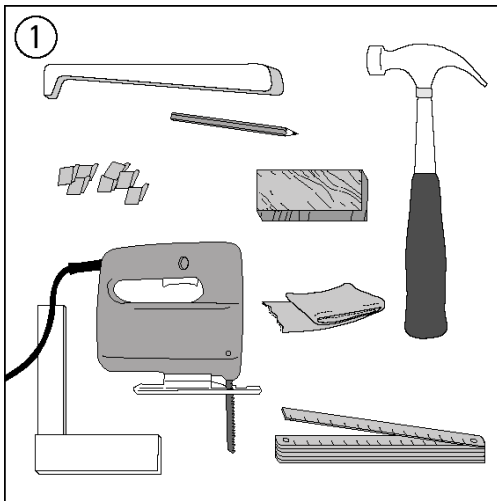
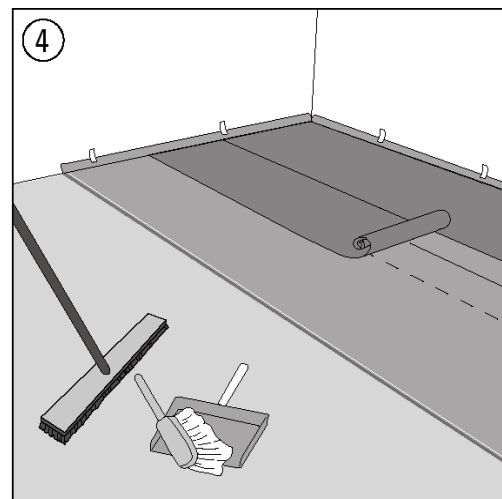
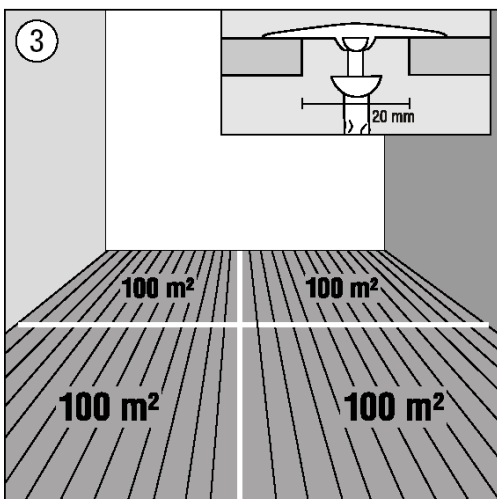

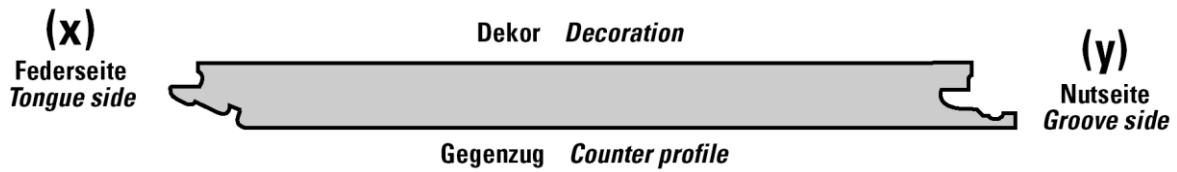

- a) Now the first panel can be installed. You should begin in the left-hand corner of the room and lay the panel so that the tongue (x) faces the wall.
- b) Pay attention that it is constantly at a distance of 10mm from the wall; this can be adjusted with the wedges. The gap at the edge of the long side (approx. 10mm) can be adjusted later, when three rows have been installed. Installation is continued using the remaining piece of the first row for the beginning of the next row. You should ensure that the end seam overlap is a minimum of 300mm. If necessary, you should cut/use a new panel.

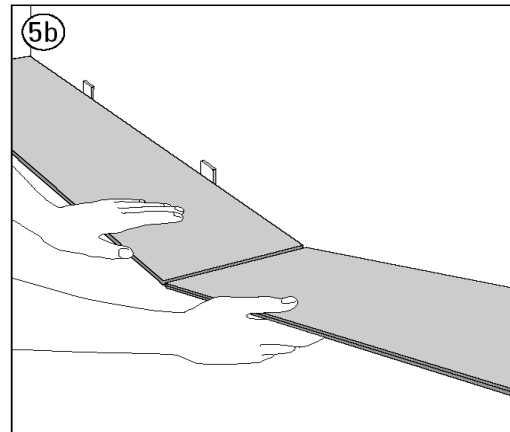
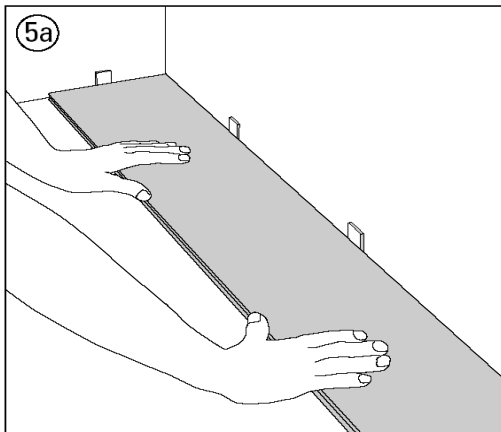

- 5) Insert the first panel of the second row into the groove side of the panel already in place. Lay it completely flat down on the floor.

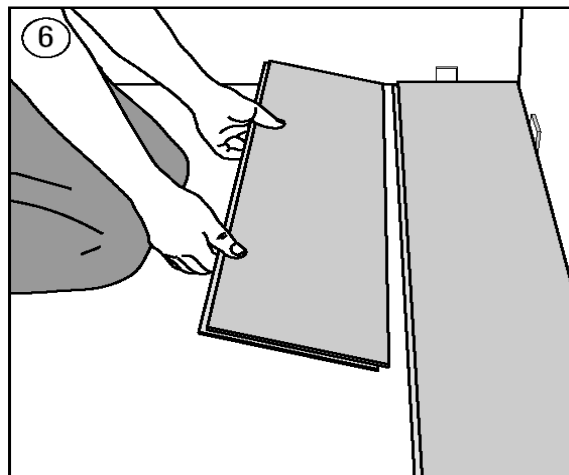

- a) Take the next panel and install it on the short side into the first panel of the second row, which is still lying flat on the floor. You should take care that this panel is on the long edge as close as possible to the first row (the tongue should touch the edge of the first row).
- b) Put your fingers from both hands under the second panel of the second row (near to the joint with the first panel) (while kneeling on the first row), lift up slightly on the panel. The first panel of the second row will also lift up slightly. Now pull the panel towards the first row. Now lay the panels flat, the joint should be closed by now. If not, please repeat and pull with more force. (If the joint between the first panel of the second row and the first row opens up, this is easily corrected. Now you have joined the first few panels and have got used to the techniques.

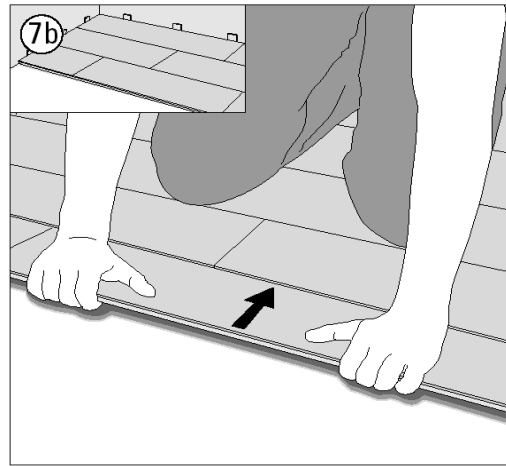
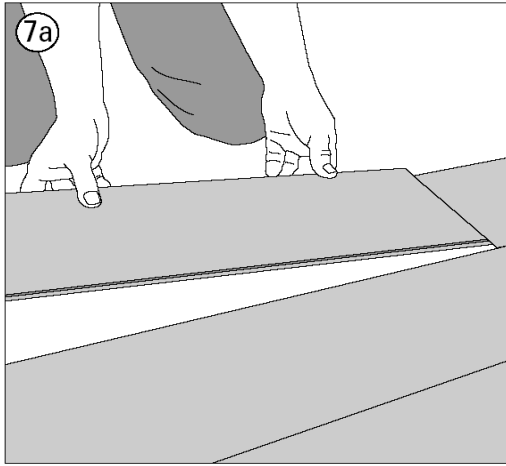

c)

**6) The last panel in a row is fitted as follows:**

- a) Turn the panel so that the groove side lies at the groove side and the panel with the front side has a distance of 10mm from the wall. With the aid of a square, transfer the front joint of the laminate panel laid in front of it.
- b) Now you should saw the panel, which has been marked in this way to the length and fit it in. Here is a tip: You can achieve edges without damage by sawing on the reverse side of the decoration and using a circular saw. This panel should be joined with the aid of a tensioning tool.

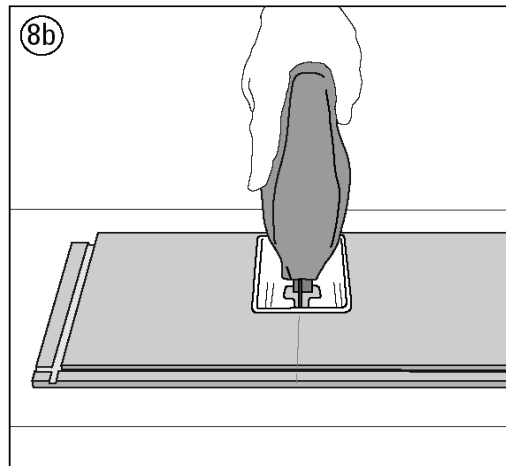
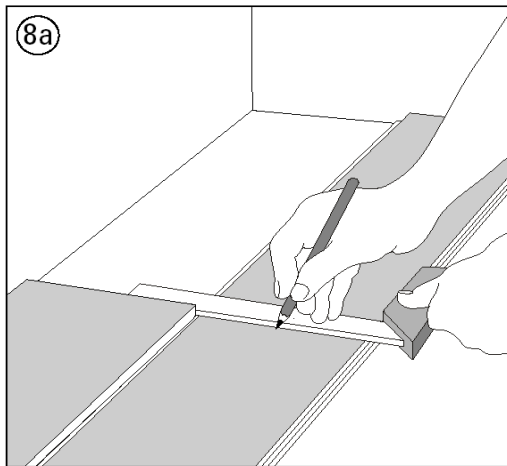

For heating pipes - such as radiator pipes - you should drill and saw, depending on the position of the pipes, as shown in the sketch, in case, you should take account of the essential expansion distance of 10mm in each direction: i.e. the diameter of the drill must be 20mm greater than the actual diameter of the pipe.

- 7) Existing doorframes can be shortened, in order that the laminate can be installed under these. You need to maintain an expansion space of 10mm, around the fixed objects under the doorframe. If the panel cannot be installed at the proper angle, it will be necessary to use a tapping block and a hammer, or a tensioning tool, in order to push the panels into one another. If necessary plane the joint side, in order to achieve this requirement. If the doors have not been undercut, then a 10mm expansion gap must exist in front, between the laminated flooring and the doorframe.

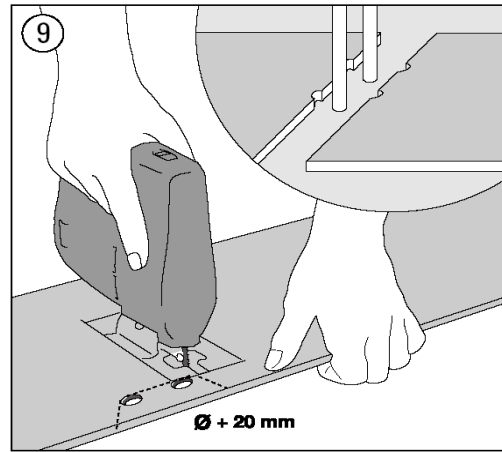
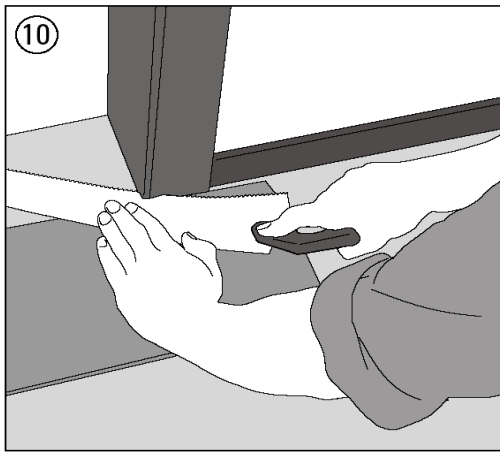

### 8) Unevenness in the wall/loosening of the joints:

- The first flooring series sometimes has to be adjusted to take account of an uneven wall. For this purpose, first of all transfer the contour of the wall to the panels. Do not forget the gap of 10 mm.
- Then loosen the panels and saw off the panels accordingly.
- You should never bend the panels, which have been joined together backwards, as they may be damaged.
- Lay the cut out flooring panels again from left to right. Press the first panel using the groove-jointing ledge into the second panel.

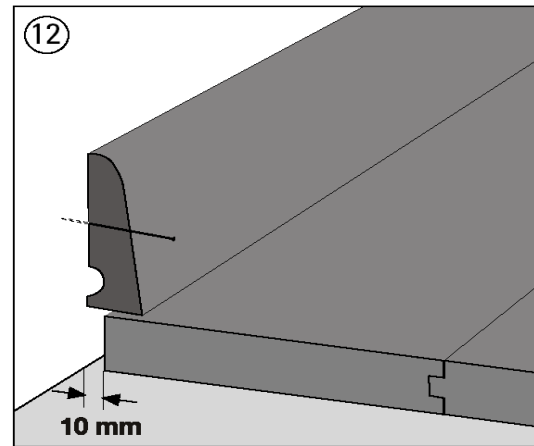
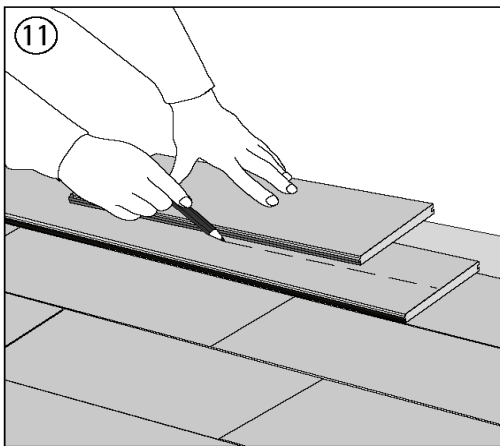

### The last row

Fit the last row by laying the particular panel congruent with the series, which was last laid. Using a remaining laminate piece with the original length and a pencil, transfer the course of the wall onto the panel, as you would with a stencil. You should take this into consideration already when determining the width of the first floor board series. Lay the cut-out panel in the guide groove of the previous series and join, as usual, using the tensioning tool.

### 9) Final work

- It is possible to walk on the floor immediately after laying the last element. This is the great advantage of the glue-free system.
- Remove all the spacer blocks
- Lay the skirting-boards without fixing these to the floor; in order that flooring can expand.
- Settling gaps in front of pipes etc. are covered with rosettes or sealed with a lasting elastic joint paste.
- At points at which no profile or base strips can be laid, the border gaps must be sealed with a lasting elastic substance (6 mm filler twine, foam cord).
- Do not burn laminate residue in private ovens, fireplaces or similar installations.

## Cleaning and care

- Laminate floorings are easy to maintain. The first prerequisite for care and preservation of the flooring is a compensated room climate (40-65% relative humidity at 20° C. These values ensure a healthy room climate.)
- In cold periods, in which heating is used, the relative humidity can sink to a very low level, at which the floor is exposed to extreme drying out. This may result in small cracks arising. Using an air humidifier in the room can prevent these.
- You should clean laminated flooring with a vacuum cleaner or broom (no beater bar vacuum). In the event of light dirtying, you should dry mop the floor with a well-wrung mop. You should use water sparingly. Do not use any form of cloth mop, as this spreads large amount of water on the floor. You should use clear mopping water without additives or water with laminate cleaner. After mopping the floor with the clean cloth, dry thoroughly. You should immediately clean up any puddles of water.
- Problem stains such as paint, glue, asphalt, oil, etc. can be removed easily, quickly and thoroughly with a basic laminate cleaner.
- You should carefully observe the manufacturer's instructions.
- The laminate flooring is very resistant. It does not require any special treatment. The surface consists of high quality melamine resins, not of wood. You should therefore dispense completely with floor polish, polish and preservative dispersions.

**Warning! You should never use any vapour/steam cleaning equipment, and the panels should never be sanded or re-coated.**

## Preventive measures

- Protect flooring surface with felt pads under furniture legs.
- You should use chair rollers with soft rollers and ones which are suitable for laminate floorings. Where there are outside doors, you should make sufficiently large walking areas or floor mats available.
- With under floor heating, the laminate surface temperature should be < 28° C. This applies particularly in the case where rugs are present.



Proudly distributed in Australia by



14-16 Lakewood Boulevard Braeside  
Victoria 3195  
P: +61 3 9587 4344 E: [enquiry@floatingfloors.com.au](mailto:enquiry@floatingfloors.com.au)